

RUNWAY/TAXIWAY/APRON PHYSICAL CHARACTERISTICS		
RWY / TWY / APRON	SURFACE	BEARING STRENGTH
RWY 05/23	Asphalt	48/F/B/X/U
Air-Lock Apron	Asphalt	53/R/B/X/U
Bravo Apron	Concrete	48/R/B/X/T
Dakota Apron	Asphalt	53/R/B/X/U
Hangar 4 Apron	Asphalt	53/R/B/X/U
West Apron	Asphalt	53/R/B/X/U
Eastern Light Apron	Grass	-
Grass Link (TWY K to J)	Grass (15m)	-
TWY A (Airpark to TWY K)	Asphalt	53/R/B/X/U
TWY A (TWY B to Airpark)	Grass	-
TWY A (West to TWY B)	Asphalt	53/R/B/X/U
TWY A (RWY to West)	Asphalt	48/F/B/X/U
TWY B (RWY to hold B1)	Asphalt	19/F/A/X/T
TWY B (hold B1 to B2)	Asphalt	19/F/A/X/T
TWY B (Bravo Taxiway)	Concrete	48/R/B/X/T
TWY C	Asphalt	19/F/A/X/T
TWY E	Asphalt	48/F/B/X/T
TWY J	Grass/5m Asphalt	-
TWY K	Asphalt	53/R/B/X/U

STAND	COORDINATES
1	522217.66N 0012858.71W
2	522202.04N 0012920.19W
3	522201.48N 0012919.59W
4	522200.93N 0012919.00W

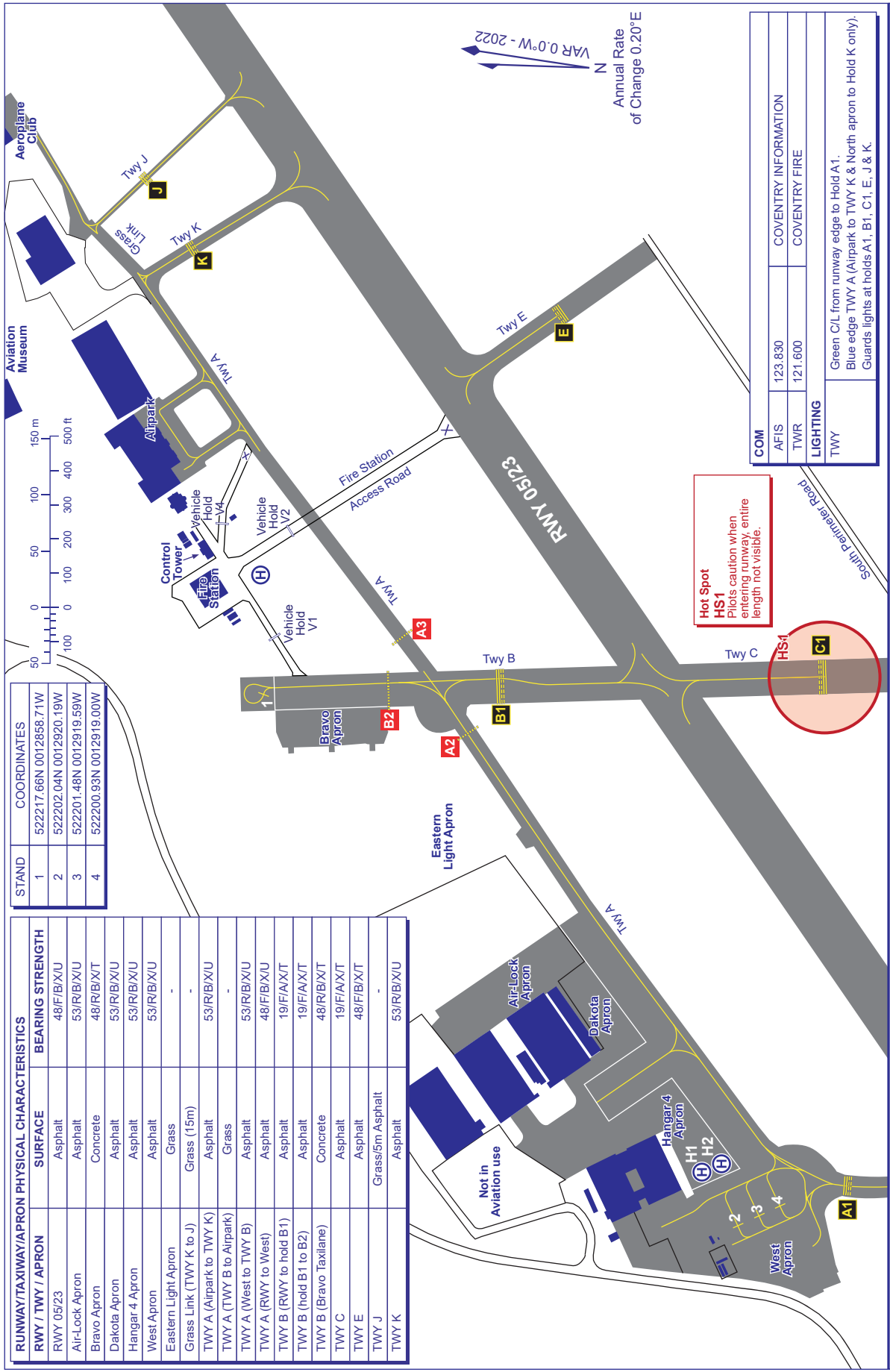

COM		COVENTRY INFORMATION	
AFIS	123.830	COVENTRY FIRE	
TWR	121.600		
LIGHTING			
TWY		Green CIL from runway edge to Hold A1. Blue edge TWY A (Airpark to TWY K & North apron to Hold K only). Guards lights at holds A1, B1, C1, E, J & K.	